

FEATURES:

- ✓ Architectural luminaire with direct distribution.
- ✓ Light source: LED board or LED strip.
- ✓ Even illumination is provided by a high-efficiency opal lens.
- ✓ Suitable for surface, suspended and recessed installations.
- ✓ Extruded aluminum body comes with a standard black or white finish.
- ✓ Also available with custom color options.
- ✓ LED strips are rated for 60,000 hrs. L80 with +90 CRI.
- ✓ Has a proven record in office, commercial and retail installations.
- ✓ Custom modifications are available.
- ✓ ED luminaires are certified to CSA and UL standards.

reinventlight

SPECIFICATION:

ED SQUARE+ — — — — — — — — — —

Enter the Product Code into the boxes above.

SIZE

_____ ft
2-8 ft Arm length.

SOURCE

- ☐ 5 W/ft
☐ 7 W/ft
☐ 10 W/ft

RADIANCE

- ☐ DD - Direct

VOLTAGE

- ☐ UNV - 120/277V
☐ 347V ¹
1. Verify availability.

DRIVER

- ☐ ST - On/Off
☐ DL - 0-10V Dim (1%)
☐ DLO - 0-10V Dim (to Off)
☐ DL2 - 0-10V Dim (TW)
☐ DLA - 0-10V Dim (Aux)
☐ DA4 - DALI D4i
☐ CV - Constant Voltage (RGBW)
☐
Specify dimming protocol.

MOUNTING

- ☐ S6B - 6ft Cord BK ¹
☐ S6W - 6ft Cord WH ¹
☐ S ft ²
☐ SF - Surface Mount
☐ RT - Recessed Trimless
1. Canopy match the Cord color.
2. Specify Suspension length/color.

LENS

- ☐ OP - Opal

FINISH

- ☐ BK - Black¹
☐ WH - White²
☐ CF/RAL
1. RAL 9005
2. RAL 9016
Specify required RAL number.

CCT

- ☐ 30K - 3000 Kelvin/90CRI
☐ 35K - 3500 Kelvin/90CRI
☐ 40K - 4000 Kelvin/90CRI
☐ RGBW ¹
☐ TW - Tunable White (27K-65K)²
☐
1. Available with DMX or CB.
2. Available with DL2, DA4 or CB.
Specify required CCT.

OPTIONS

- ☐ No Options¹
☐ EC - Emergency Circuit
☐ CB - Casambi Bluetooth(TW, RGBW)
☐ DMX - DMX (RGBW)
☐ JD - JDRF Autonomy Sensor (DA4)
☐ DOS - Daylight & Occupancy Sensor (DLA)
☐ AWN - Athena Wireless Node (DLA)
1. Leave empty.

LUMEN OUTPUT W/ft:

Watts	30K	35K	40K
5 W	515 lm	525 lm	535 lm
7 W	720 lm	735 lm	750 lm
10 W	1030 lm	1050 lm	1080 lm



Declare.

Project:

Type:

SIZE:

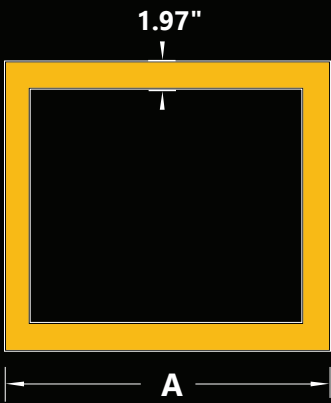
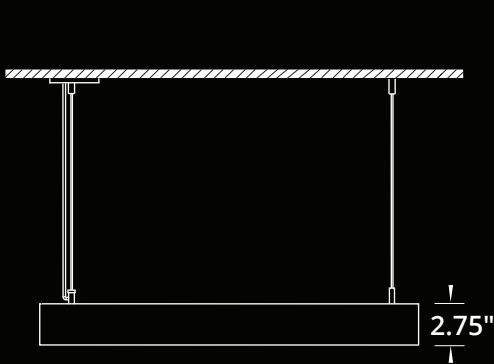

RADIANCE:

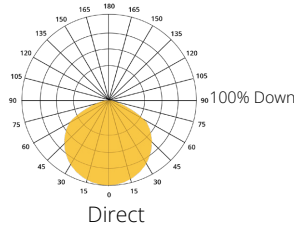

MOUNTING:

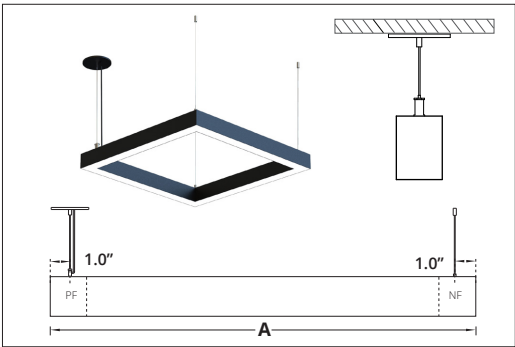

SUSPENDED
PF - Power Feed
NF - Non Power Feed

Size	A
2 ft	26.42 in
3 ft	37.42 in
4 ft	50.20 in
5 ft	61.20 in
6 ft	73.92 in
7 ft	84.92 in
8 ft	97.67 in

A - Arm Length

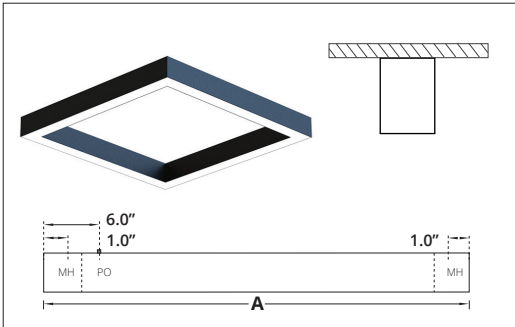

SURFACE MOUNT
PO - Power Opening
MH - Mounting Hole

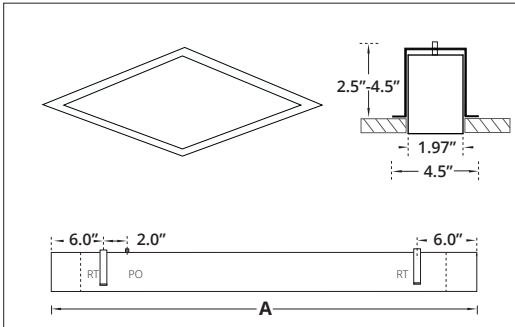

RECESSED TRIMLESS
PO - Power Opening
RT - Recessed Trimless Bracket
Cutout Dimensions = Total Length x Width of Extrusion.