

FEATURES:

- ✓ Architectural linear luminaire with direct or direct/indirect distribution.
- ✓ Light source: LED board or LED strip.
- ✓ Even illumination is provided by high efficiency opal lenses.
- ✓ Available for row-mounted installations in various lengths.
- ✓ Suitable for surface, suspended, recessed or wall mounted installations.
- ✓ Extruded aluminum body comes with a standard black or white finish.
- ✓ Also available with various custom color options.
- ✓ LED strips are rated for 60,000 hrs. L80 with +90 CRI.
- ✓ Has a proven record in office, commercial and retail installations.
- ✓ Custom modifications are available.
- ✓ ED luminaires are certified to CSA and UL standards.

reinventlight

SPECIFICATION:

ED VECTOR2+

SIZE	SOURCE	RADIANCE	VOLTAGE	DRIVER	MOUNTING	LENS	FINISH	CCT	OPTIONS
<input type="text"/>	<input type="text"/>	<input type="text"/>	<input type="text"/>	<input type="text"/>	<input type="text"/>	<input type="text"/>	<input type="text"/>	<input type="text"/>	<input type="text"/>

Enter the Product Code into the boxes above.

SIZE

____ Feet*

*1-8 Feet
Continuous Run
(0.5 Feet Increments)

SOURCE

- ☐ 5W/FT LED
- ☐ 7W/FT LED
- ☐ 10W/FT LED

RADIANCE

- ☐ DD - Direct (100%Down)
- ☐ UD - Uneven (70%Down/30%Up)**
- *Light distribution.
- **Not available for sizes shorter than 4Feet.

VOLTAGE

- ☐ 120V
- ☐ 277V
- ☐ 347V*
- *Not available for all configurations.

DRIVER

- ☐ ST - On/Off
- ☐ DL - 0-10V Dim (1%)
- ☐ DLO - 0-10V Dim (to Off)
- ☐ DL2 - 0-10V Dim (TW)
- ☐ DA4 - DALI D4i
- ☐ DMX - DMX RGBW
- ☐ EM - Emergency Driver*
- ☐ **
- *Battery Pack min. 4Feet section.
- **Specify dimming protocol.

MOUNTING

- ☐ S6W - 6Ft Cord WH*
- ☐ S6B - 6Ft Cord BK*
- ☐ S Feet**
- ☐ WM - Wall Mount
- ☐ WF - Wall Flush
- ☐ SF - Surface Mount
- ☐ RT - Recessed Trimless

*Canopy will match the Cord color.

**Specify Suspension length and color.

LENS

- ☐ OP - Opal
- ☐ OR - Opal Regressed

FINISH

- ☐ BK - Black*
- ☐ WH - White**
- ☐ CF/RAL ***
- *RAL 9005
- **RAL 9016
- ***Specify required RAL number.

CCT

- ☐ 30K - 3000 Kelvin/90CRI
- ☐ 35K - 3500 Kelvin/90CRI
- ☐ 40K - 4000 Kelvin/90CRI
- ☐ RGBW
- ☐ TW - Tunable White*
(2700K-6500K)
- ☐ **
- *Available with 0-10V, Dali or Bluetooth controls.
- **Specify required CCT.

OPTIONS

- ☐ No Options*
- ☐ DR - Damp Rated
- ☐ DC - Dual Circuit**
- ☐ CB - Casambi/Bluetooth
- ☐ JD - JDRF Autonomy Sensor
- ☐ DOS - Daylight & Occupancy Sensor
- ☐ ***
- *Leave empty.
- **Control Downlight/Uplight separately.
- ***Specify required option.

LUMEN OUTPUT W/Ft:

Watts	30K	35K	40K
5W	515 lm	525 lm	535 lm
7W	720 lm	735 lm	750 lm
10W	1030lm	1050 lm	1080 lm



Project:

Type:

SIZE:

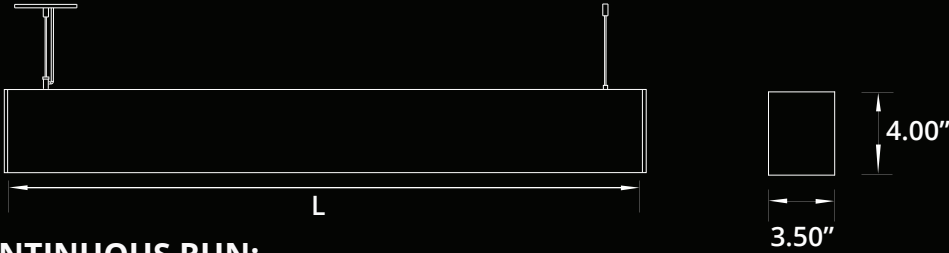

Size	L (LENGTH)
1 Feet	11.50 Inch
2 Feet	24.25 Inch
3 Feet	35.25 Inch
4 Feet	48.00 Inch
5 Feet	59.00 Inch
6 Feet	71.75 Inch
7 Feet	82.75 Inch
8 Feet	95.50 Inch

Total length with endcaps = L + 0.22"

CONTINUOUS RUN:



RADIANCE:

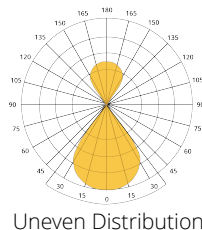
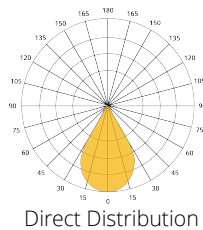

MOUNTING:

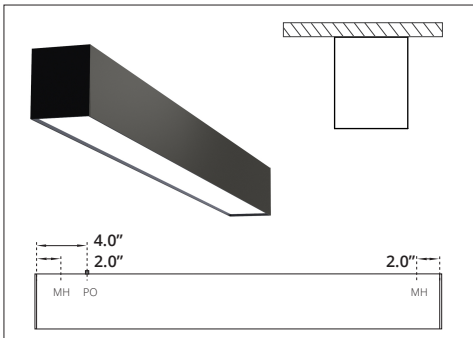

SURFACE MOUNT

MH - Mounting Hole
PO - Power Opening

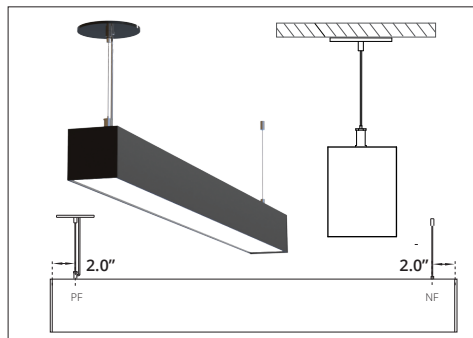

SUSPENDED

PF - Power Feed
NF - Non Power Feed

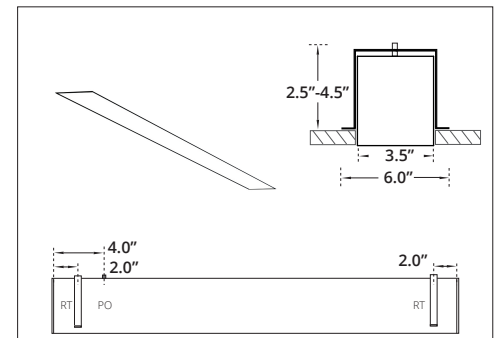

RECESSED TRIMLESS

RT - Recessed Trimless Bracket
PO - Power Opening
*Cutout Dimensions = Total Length x Width of Extrusion.

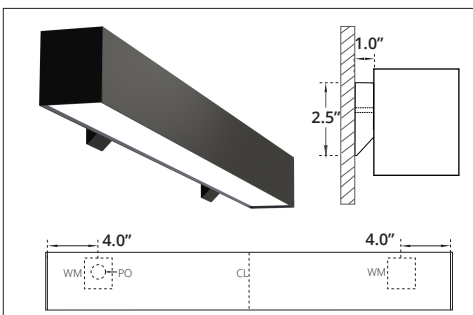

WALL MOUNT

PO - Power Opening
WM - Wall Mount Bracket
*1-3 Feet, single Wall Mount Bracket with Power Opening in the centre.

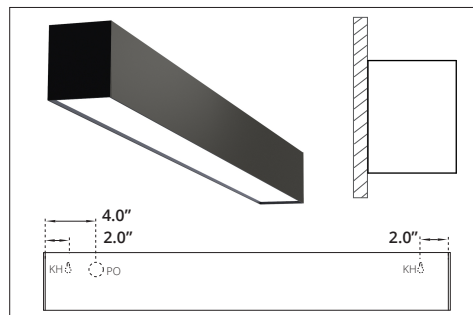

WALL FLUSH

KH - Key Hole
PO - Power Opening

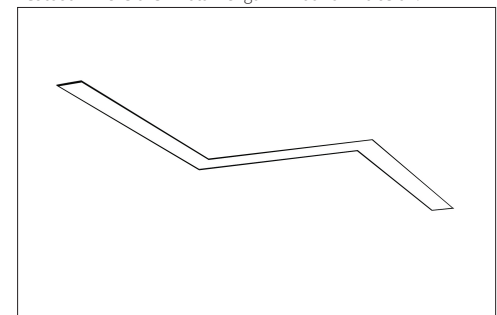

VARIABLE ANGLE

60°, 90°, 120°, 135° or Custom.