

- ✓ Architectural linear luminaire with direct or direct/indirect distribution.
- ✓ Light source: LED board or LED strip.
- ✓ Even illumination is provided by high efficiency opal lenses.
- ✓ Available for row-mounted installations in various lengths.
- ✓ Suitable for surface, suspended, recessed or wall mounted installations.
- ✓ Extruded aluminum body comes with a standard black or white finish.
- ✓ Also available with various custom color options.
- ✓ LED strips are rated for 60,000 hrs. L80 with +90 CRI.
- ✓ Has a proven record in office, commercial and retail installations.
- ✓ Custom modifications are available.
- ✓ ED luminaires are certified to CSA and UL standards.

reinventlight

ED VECTOR2+

A diagram showing the components of a lighting fixture: SIZE, SOURCE, RADIANCE, VOLTAGE, DRIVER, MOUNTING, LENS, FINISH, CCT, and OPTIONS, each in a box connected by lines.

SIZE

SOURCE

- ## RADIANCE

- ## VOLTAGE

- ## DRIVER

- ## MOUNTING

- ## LENS

- ## FINISH

- CCT

- ## OPTIONS

- LUMEN OUTPUT W/Ft:**

Watts	30K	35K	40K
5W	515 lm	525 lm	535 lm
7W	720 lm	735 lm	750 lm
10W	1030lm	1050 lm	1080 lm



Project:

Type:

SIZE:

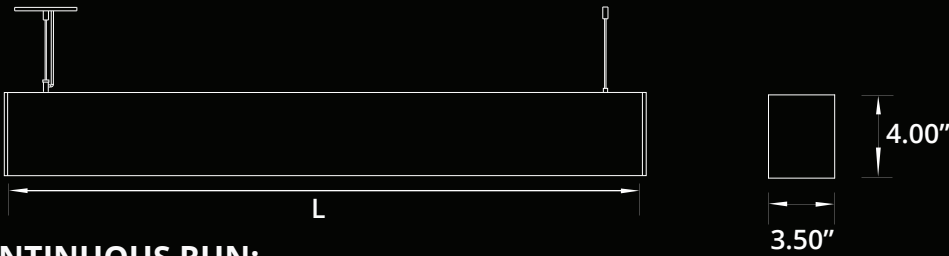

Size	L (LENGTH)
1 Ft	11.50 In
2 Ft	24.25 In
3 Ft	35.25 In
4 Ft	48.00 In
5 Ft	59.00 In
6 Ft	71.75 In
7 Ft	82.75 In
8 Ft	95.50 In

Total length with endcaps = L + 0.22"

CONTINUOUS RUN:



RADIANCE:

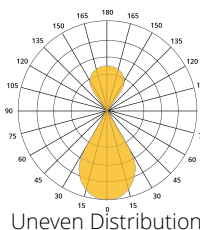
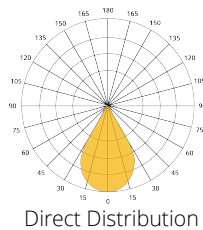

MOUNTING:

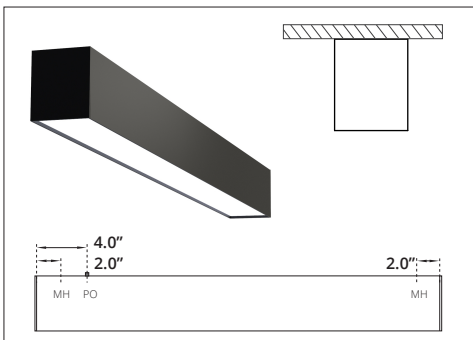

SURFACE MOUNT

MH - Mounting Hole
PO - Power Opening

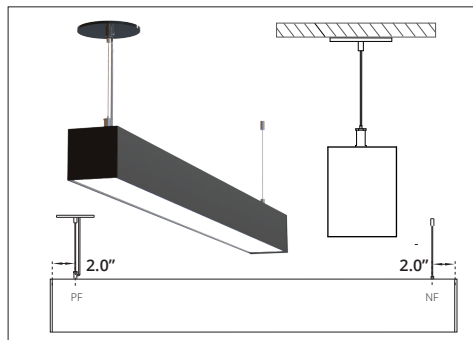

SUSPENDED

PF - Power Feed
NF - Non Power Feed

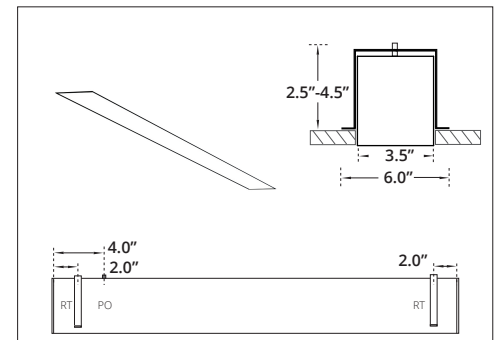

RECESSED TRIMLESS

RT - Recessed Trimless Bracket
PO - Power Opening
*Cutout Dimensions = Total Length x Width of Extrusion.

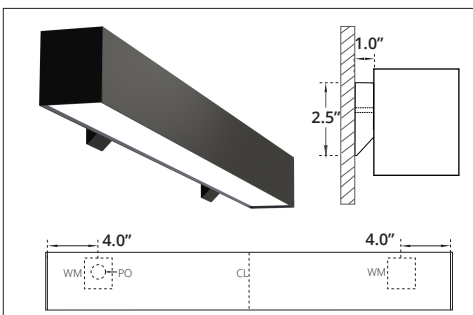

WALL MOUNT

PO - Power Opening
WM - Wall Mount Bracket
*1-3 Ft, single Wall Mount Bracket with Power Opening in the centre.

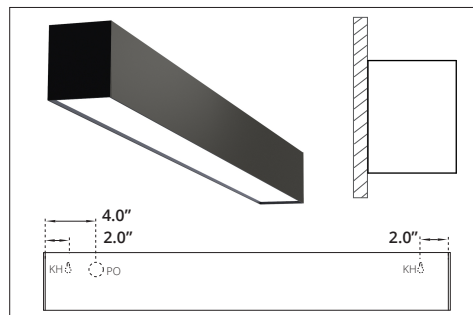

WALL FLUSH

KH - Key Hole
PO - Power Opening

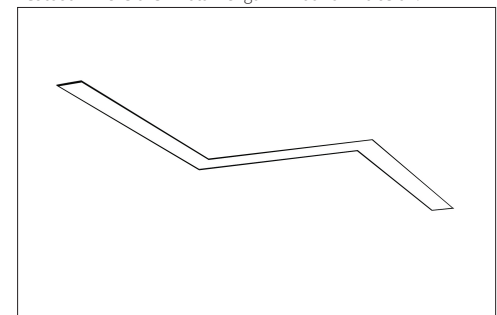

VARIABLE ANGLE

60°, 90°, 120°, 135° or Custom.