

FEATURES:

- ✓ Architectural linear luminaire with direct or direct/indirect distribution.
- ✓ Light source: LED board or LED strip.
- ✓ Even illumination is provided by a high-efficiency opal lens.
- ✓ Available for row-mounted installations in various lengths.
- ✓ Suitable for surface, suspended, recessed or wall-mounted installations.
- ✓ Extruded aluminum body comes with a standard black or white finish.
- ✓ Also available with various custom color options.
- ✓ LED strips are rated for 60,000 hrs. L80 with +90 CRI.
- ✓ Has a proven record in office, commercial, and retail installations.
- ✓ Custom modifications are available.
- ✓ ED luminaires are certified to CSA and UL standards.

reinventlight

SPECIFICATION:

ED VECTOR1+ — — — — — — — — —

Enter the Product Code into the boxes above.

SIZE

_____ Feet*

*1-8 Feet
Continuous Run
(0.5 Feet Increments)

SOURCE

- ☐ 5W/Ft LED
☐ 7W/Ft LED
☐ 10W/Ft LED

RADIANCE

- ☐ DD - Direct (100%Down)
☐ UD - Uneven (70%Down/30%Up)**

*Light distribution.
**Not available for Surface Mount configuration.

VOLTAGE

- ☐ 120V
☐ 277V
☐ 347V*

*Not available for all configurations.

DRIVER

- ☐ ST - On/Off
☐ DL - 0-10V Dimming (1%)
☐ DLO - 0-10V Dimming (to Off)
☐ DL2 - 0-10V Dimming (2 Channels)
☐ DA4 - DALI D4i
☐ DMX - DMX RGBW
☐ EM - Emergency Driver*
☐ **

*Battery Pack min. 4Feet section.
**Specify dimming protocol.

MOUNTING

- ☐ S6W - 6Ft Cord WH*
☐ S6B - 6Ft Cord BK*
☐ S Feet**
☐ WM - Wall Mount
☐ WF - Wall Flush
☐ SF - Surface Mount
☐ RT - Recessed Trimless

*Canopy will match the Cord color.
**Specify Suspension length and color.

LENS

- ☐ OP - Opal

FINISH

- ☐ BK - Black*
☐ WH - White**
☐ CF/RAL ***

*RAL 9005
**RAL 9016
***Specify required RAL number.

CCT

- ☐ 30K/90CRI - 3000 Kelvin
☐ 35K/90CRI - 3500 Kelvin
☐ 40K/90CRI - 4000 Kelvin
☐ RGBW
☐ TW - Tunable White*
(2700K-6500K)
☐ **

*Available with 0-10V, Dali or Bluetooth controls.
**Specify required CCT.

OPTIONS

- ☐ No Options*
☐ DR - Damp Rated
☐ DC - Dual Circuit**
☐ CB - Casambi/Bluetooth
☐ JD - JDRF Autonomy Sensor
☐ DOS - Daylight & Occupancy Sensor
☐ ***

*Leave empty.
**Control Downlight/Uplight separately.
***Specify required option.

LUMEN OUTPUT W/Ft:

Watts	30K	35K	40K
5W	515 lm	525 lm	535 lm
7W	720 lm	735 lm	750 lm
10W	1030lm	1050 lm	1080 lm



Project:

Type:

SIZE:

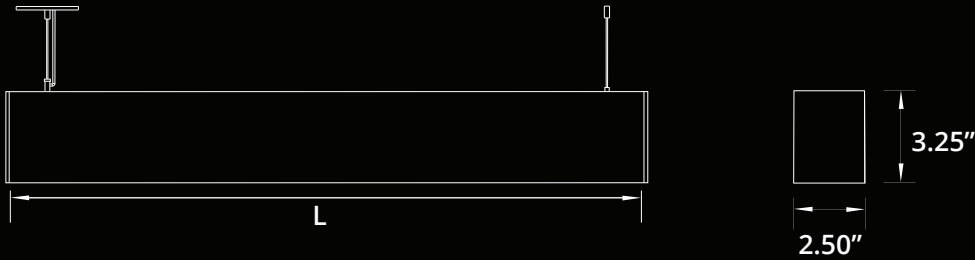

Size	L (LENGTH)
1 Feet	11.50 Inch
2 Feet	24.25 Inch
3 Feet	35.25 Inch
4 Feet	48.00 Inch
5 Feet	59.00 Inch
6 Feet	71.75 Inch
7 Feet	82.75 Inch
8 Feet	95.50 Inch

Total length with endcaps = L + 0.22"

CONTINUOUS RUN:



RADIANCE:



*Minimum 3 Feet suspension is recommended.

MOUNTING:

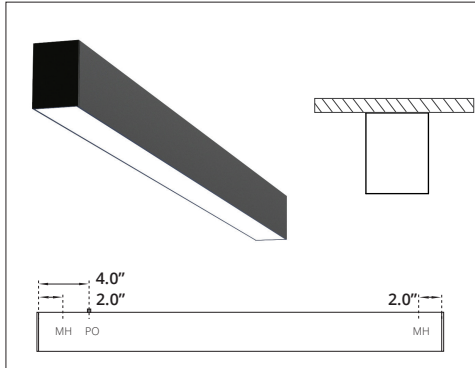

SURFACE MOUNT

MH - Mounting Hole
PO - Power Opening

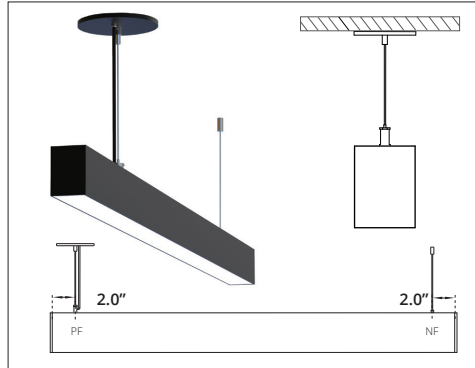

SUSPENDED

PF - Power Feed
NF - Non Power Feed

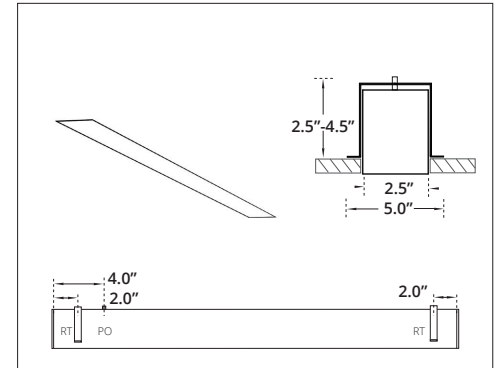

RECESSED TRIMLESS

RT - Recessed Trimless Bracket
PO - Power Opening
*Cutout Dimensions = Total Length x Width of Extrusion.

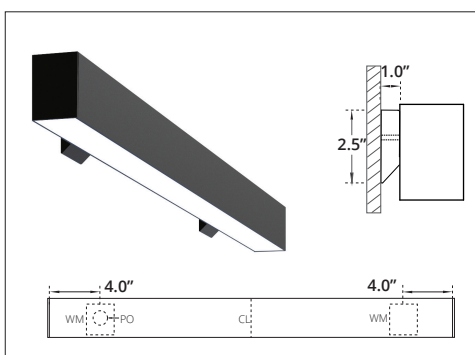

WALL MOUNT

PO - Power Opening
WM - Wall Mount Bracket
*1-3 Feet, single Wall Mount Bracket with Power Opening in the centre.

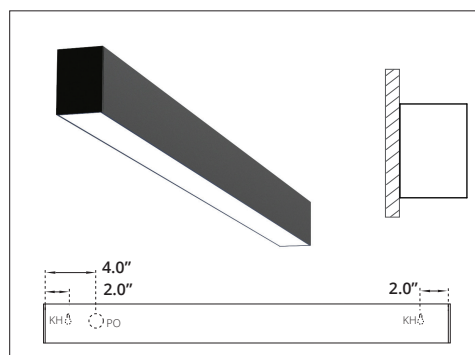

WALL FLUSH

KH - Key Hole
PO - Power Opening

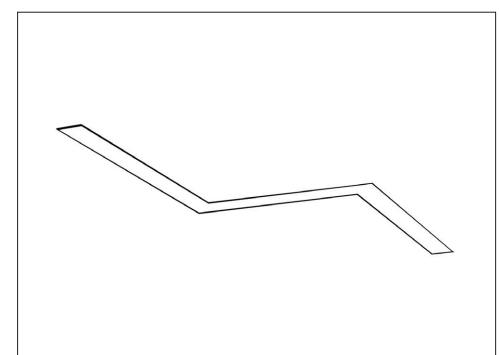

VARIABLE ANGLE

60°, 90°, 120°, 135° or Custom.